

BASELINE LAKE LIVINGSTON COUNTY, MICHIGAN MAY 22, 2019 TREATMENT MAP

Legend

 Clipper/Diquat = 0.75 acre of mixed exotics
w/flumioxazin @ 100 ppb w/diquat-dibromide

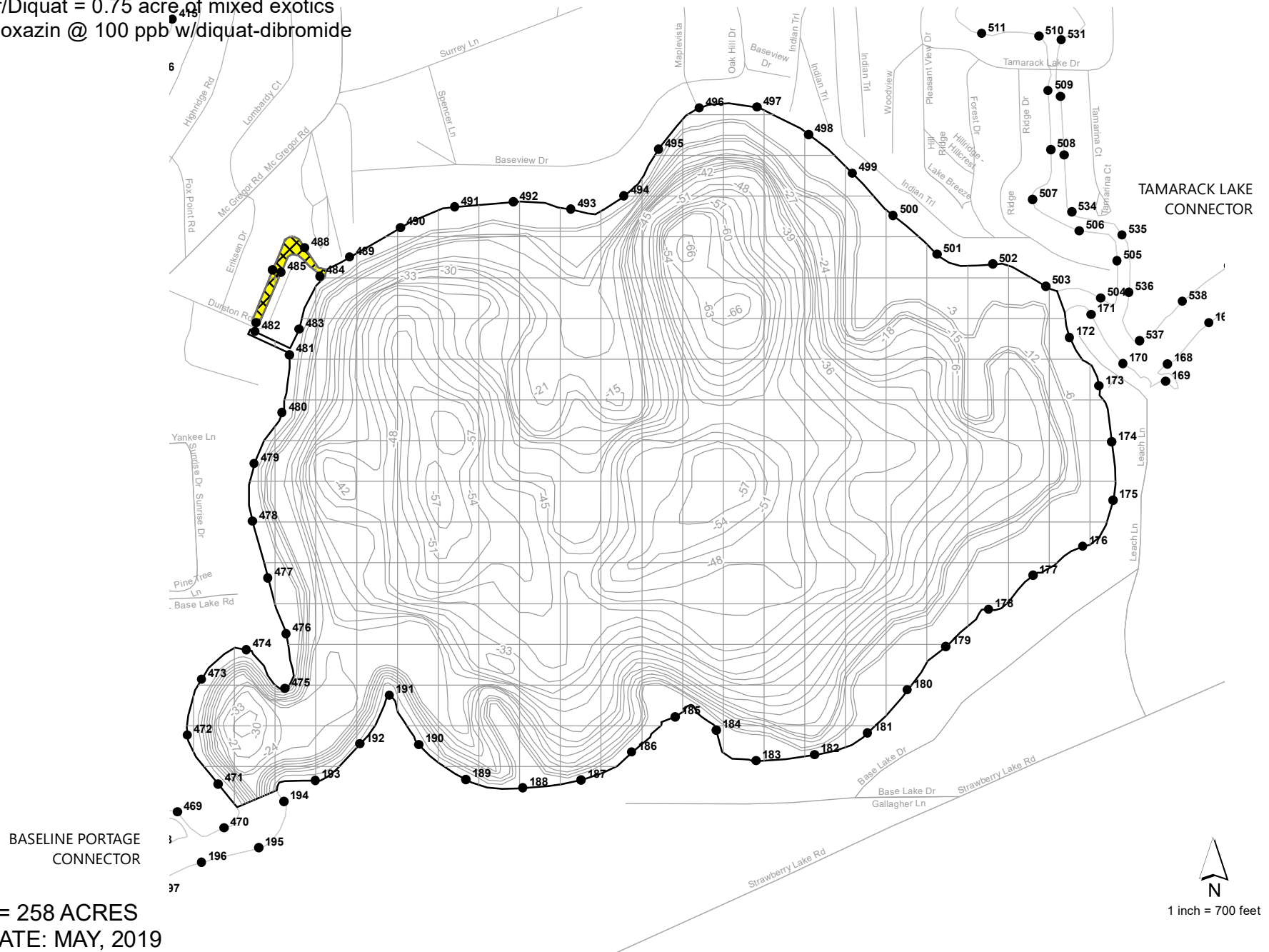

LAKE AREA = 258 ACRES
REVISION DATE: MAY, 2019