



# LITTLE PORTAGE LAKE LIVINGSTON COUNTY, MICHIGAN JUNE 11, 2019 TREATMENT MAP

## Legend

-  Algae = 2.75 acres of nuisance filamentous algae w/CuSO4
-  Clipper/Chelated Copper Ethanolamine Complex = 1 acre of starry stonewort w/flumioxazin @ 150 ppb w/Cutrine Ultra @ 4.8 gal./acre (4 ft. mean depth)
-  Clipper/Aquathol-K = 5 acres of nuisance thin-leaf pondweed w/flumioxazin @ 100 ppb w/Aquathol-K

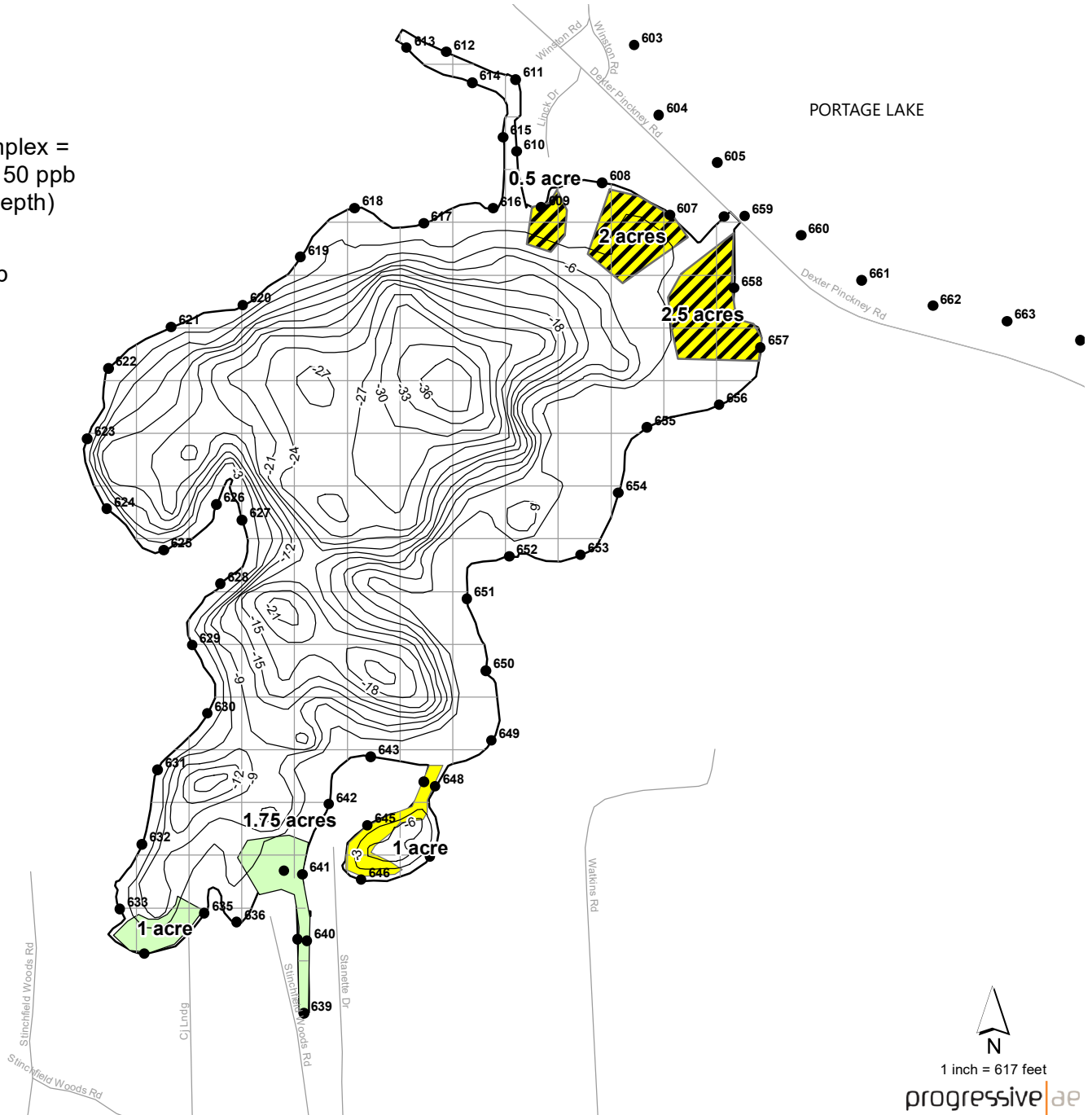

LAKE AREA = 98 ACRES  
REVISION DATE: MAY, 2019