





WHITEWOOD LAKE LIVINGSTON COUNTY, MICHIGAN JULY 2, 2019 TREATMENT MAP

Legend

 2,4-D Ester = 0.75 acre of non-native milfoil w/Navigate @ 150 lbs./acre

 Copper/Hydro = 1.5 acres of starry stonewort w/CuSO4/Hydrothol 191

 Triclopyr Dry = 3.5 acres of non-native milfoil w/Navitrol granular @ 200 lbs./acre

 Triclopyr Liquid = 0.25 acre of non-native milfoil w/Navitrol liquid @ 4 gal./acre

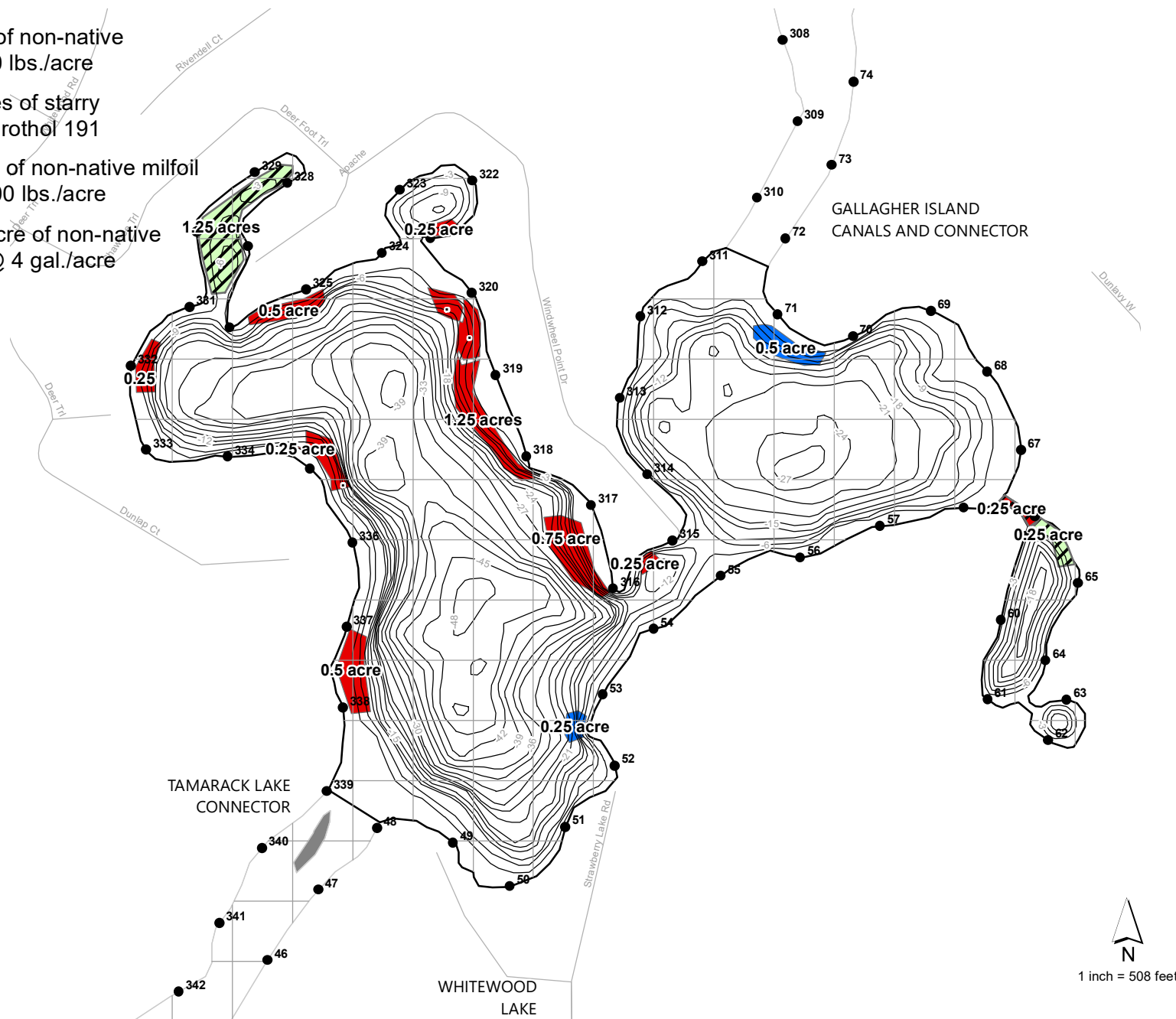

LAKE AREA = 75 ACRES
REVISION DATE: MAY, 2019