



WHITEWOOD LAKE LIVINGSTON COUNTY, MICHIGAN AUGUST 19, 2019 TREATMENT MAP

Legend

-  Diquat/Stingray = 2.25 acres of nuisance coontail and flowering rush w/diquat-dibromide and carfentrazone
-  Copper/Hydro = 4.25 acres of starry stonewort w/CuSO4/Hydrothol 191
-  Diquat Natives = 2.75 acres of milfoil and nuisance natives w/diquat-dibromide @ 2 gal./acre

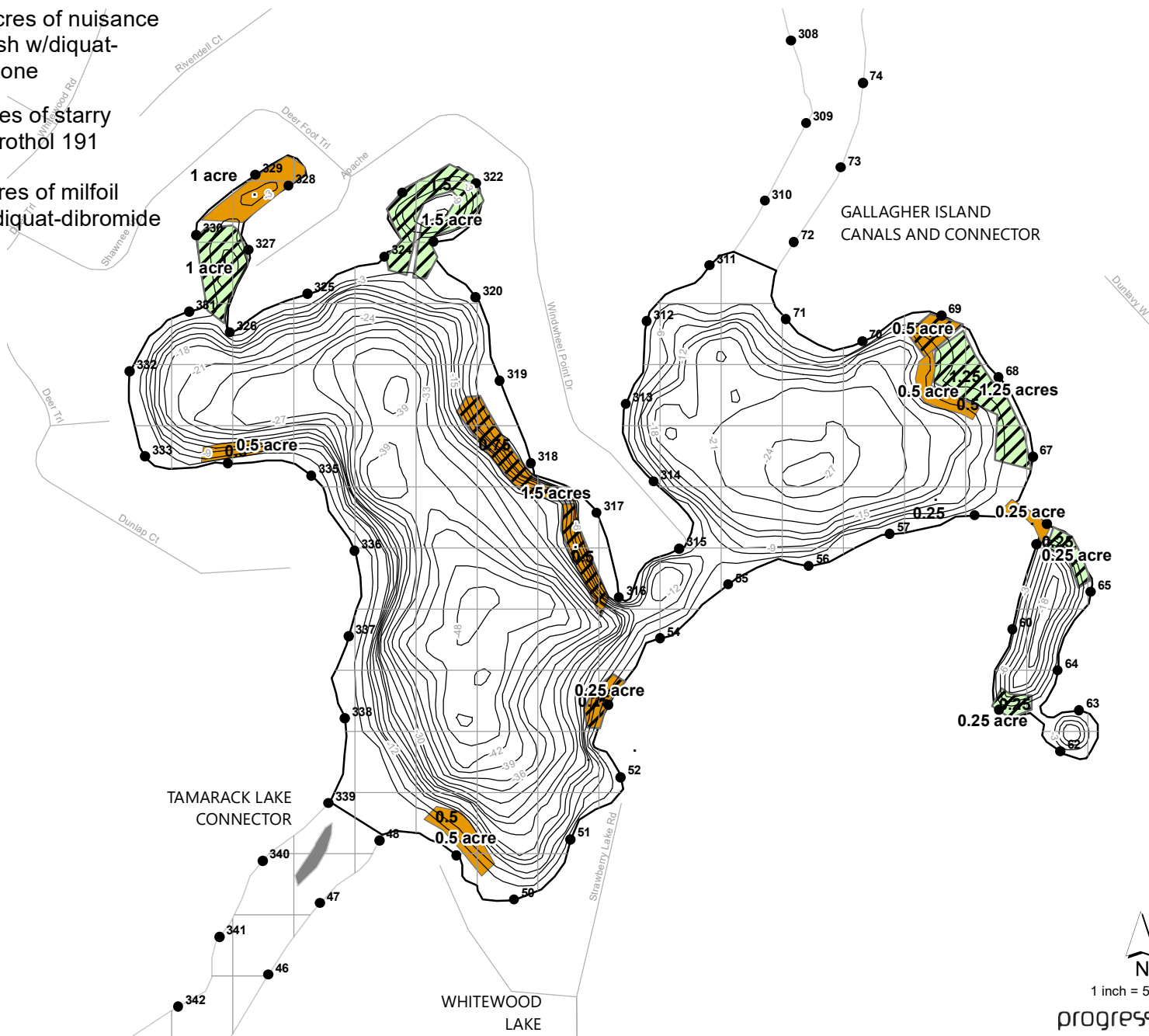

LAKE AREA = 75 ACRES
REVISION DATE: MAY, 2019