



LITTLE PORTAGE LAKE LIVINGSTON COUNTY, MICHIGAN AUGUST 19, 2019 TREATMENT MAP

Legend

-  Copper/Hydro = 6.25 acres of starry stonewort w/CuSO4/Hydrothol 191
-  Diquat Exotics = 0.75 acre of flowering rush and milfoil w/diquat-dibromide @ 2 gal./acre
-  Chelated Copper Granular = 1.25 acres of starry stonewort w/Harpoon granular @ 200 lbs./acre

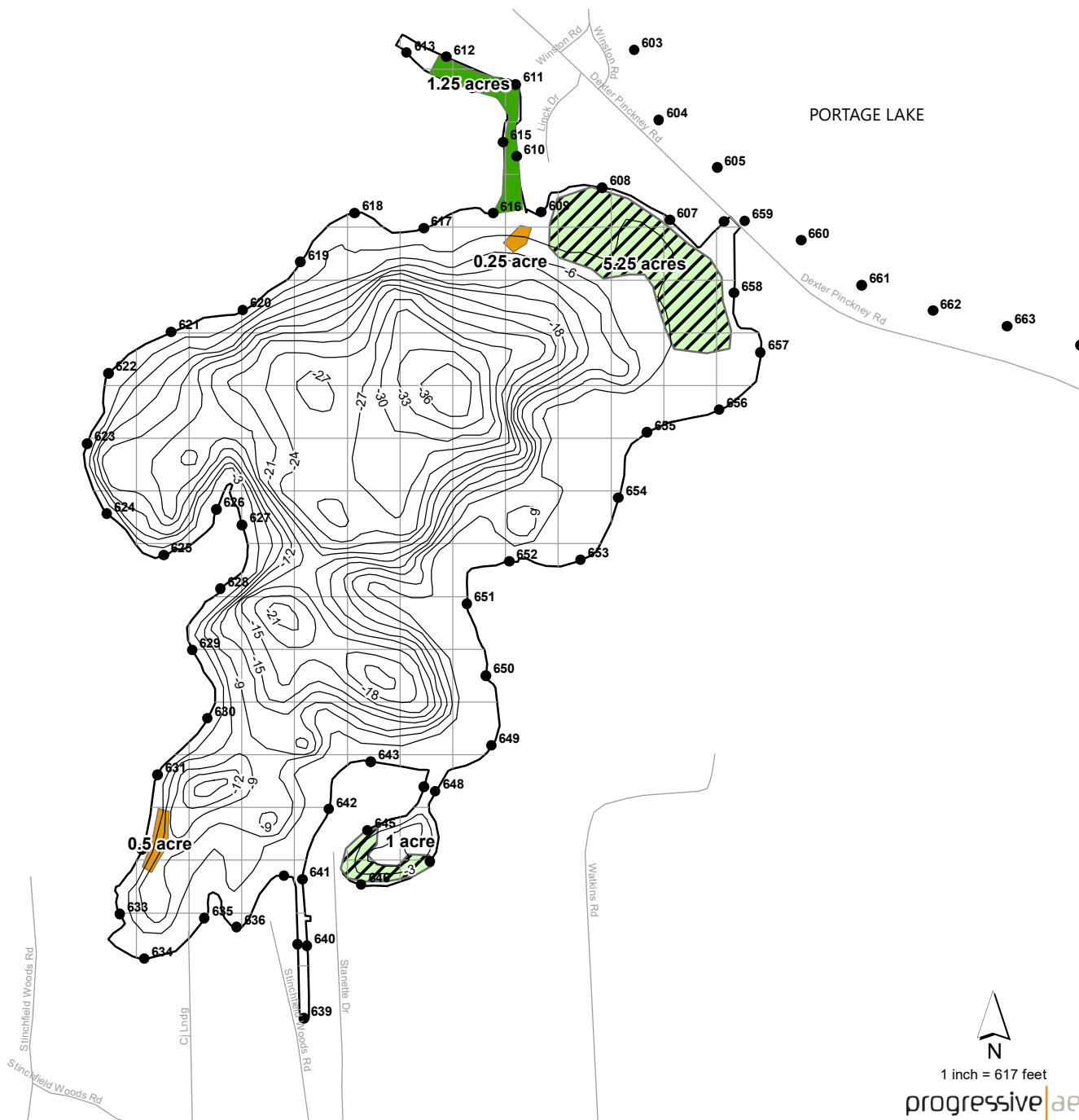

LAKE AREA = 98 ACRES
REVISION DATE: MAY, 2019