



GALLAGHER LAKE LIVINGSTON COUNTY, MICHIGAN MAY 24, 2021 TREATMENT MAP

Treatment

-  Clipper/Aquathol-K = 0.25 acre of curly-leaf pondweed w/flumioxazin @ 100 ppb w/Aquathol-K
-  Procellacor/Diquat = 7 acres of non-native milfoil w/florpyrauxifin-benzyl @ 12.8 oz./acre w/diquat-dibromide

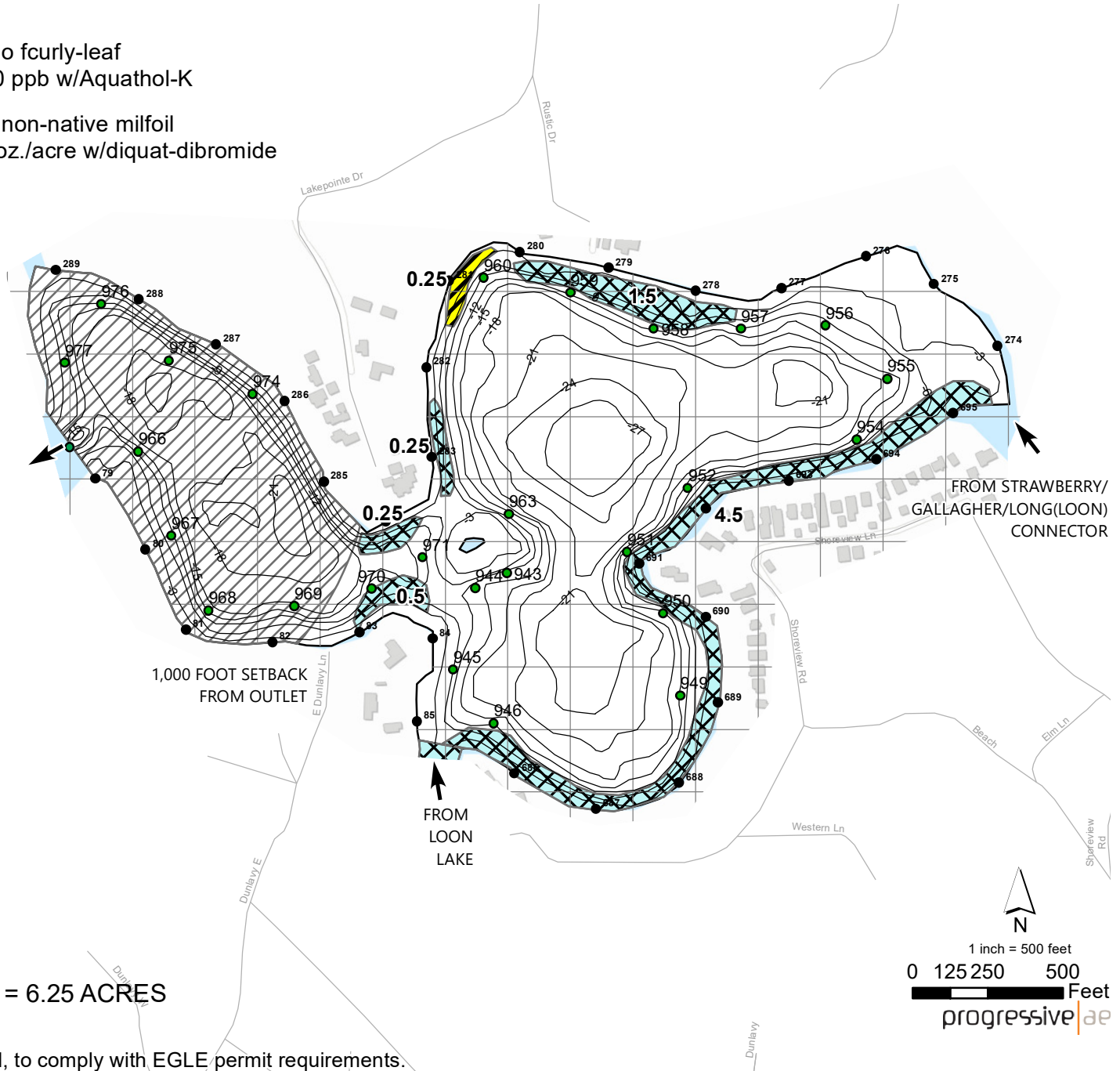

LAKE AREA = 69 ACRES
 25% OF POTENTIAL SPAWNING AREA = 6.25 ACRES
 REVISION DATE: JANUARY 2021

The applicator shall make adjustments, if needed, to comply with EGLE permit requirements.

