

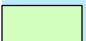



BASE LINE LAKE LIVINGSTON/WASHTENAW COUNTIES, MICHIGAN JUNE 28, 2021 TREATMENT MAP

Treatment

-  Algae = 4.5 acres of nuisance filamentous algae with chelated copper (Cutrine Ultra)
-  Chelated Copper Granular = 2 acres of stary stonewort w/Harpoon gran. @ 200 lbs./acre
-  Copper/Hydro = 1.75 acres of stary stonewort w/chelated copper ethanolamine complex/Hydrothol 191
-  Diquat = 3.5 acres of flowering rush w/diquat-dibromide @ 2 gal./ac

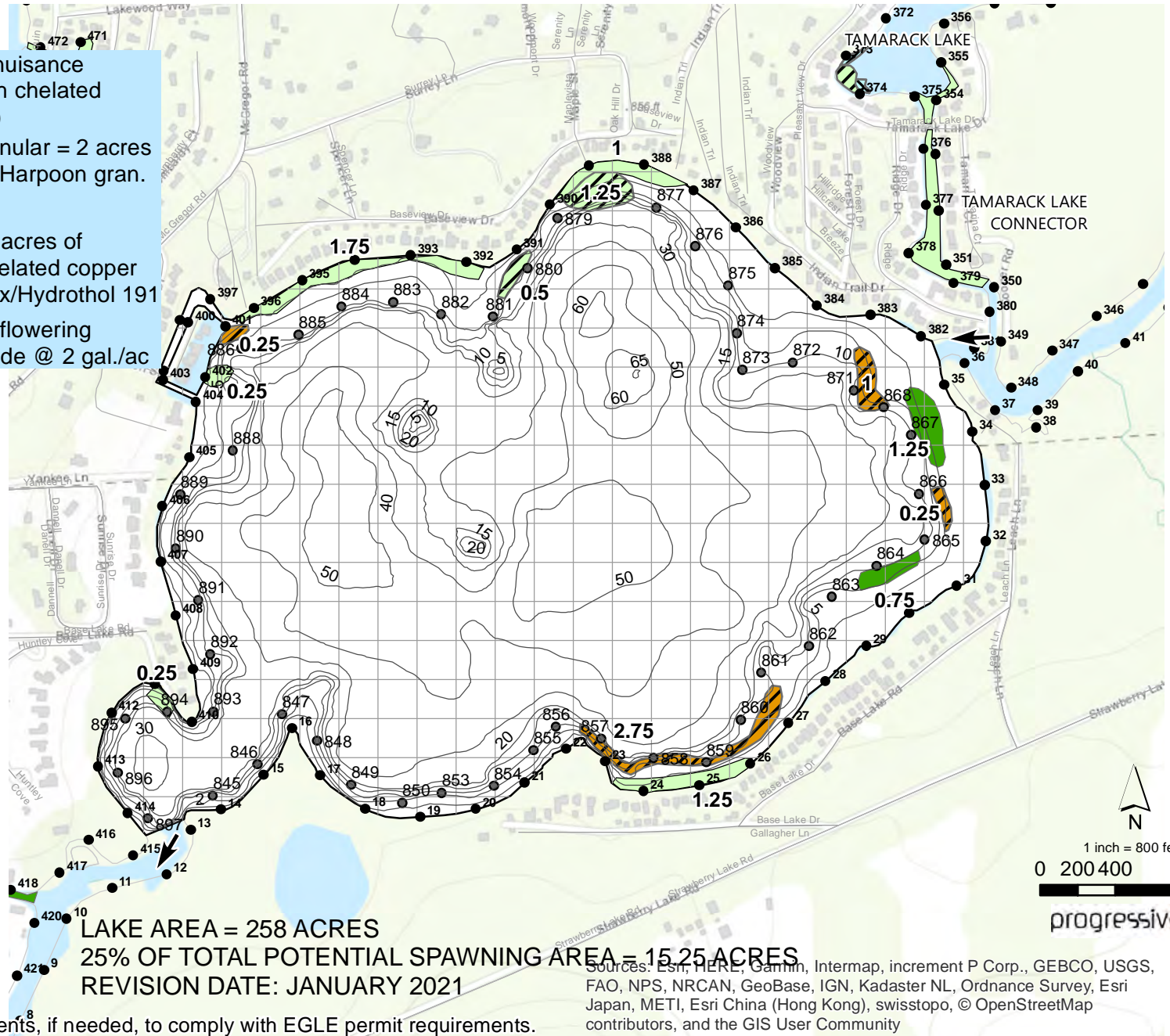

The applicator shall make adjustments, if needed, to comply with EGLE permit requirements.

Sources: Esri, HERE, Garmin, Intermap, increment P Corp., GEBCO, USGS, FAO, NPS, NRCAN, GeoBase, IGN, Kadaster NL, Ordnance Survey, Esri Japan, METI, Esri China (Hong Kong), swisstopo, © OpenStreetMap contributors, and the GIS User Community