

GALLAGHER LAKE LIVINGSTON COUNTY, MICHIGAN JUNE 28, 2021 TREATMENT MAP

Treatment

 Copper/Hydro = 0.5 acre of starry stonewort w/Cutrine/Hydrothol 191

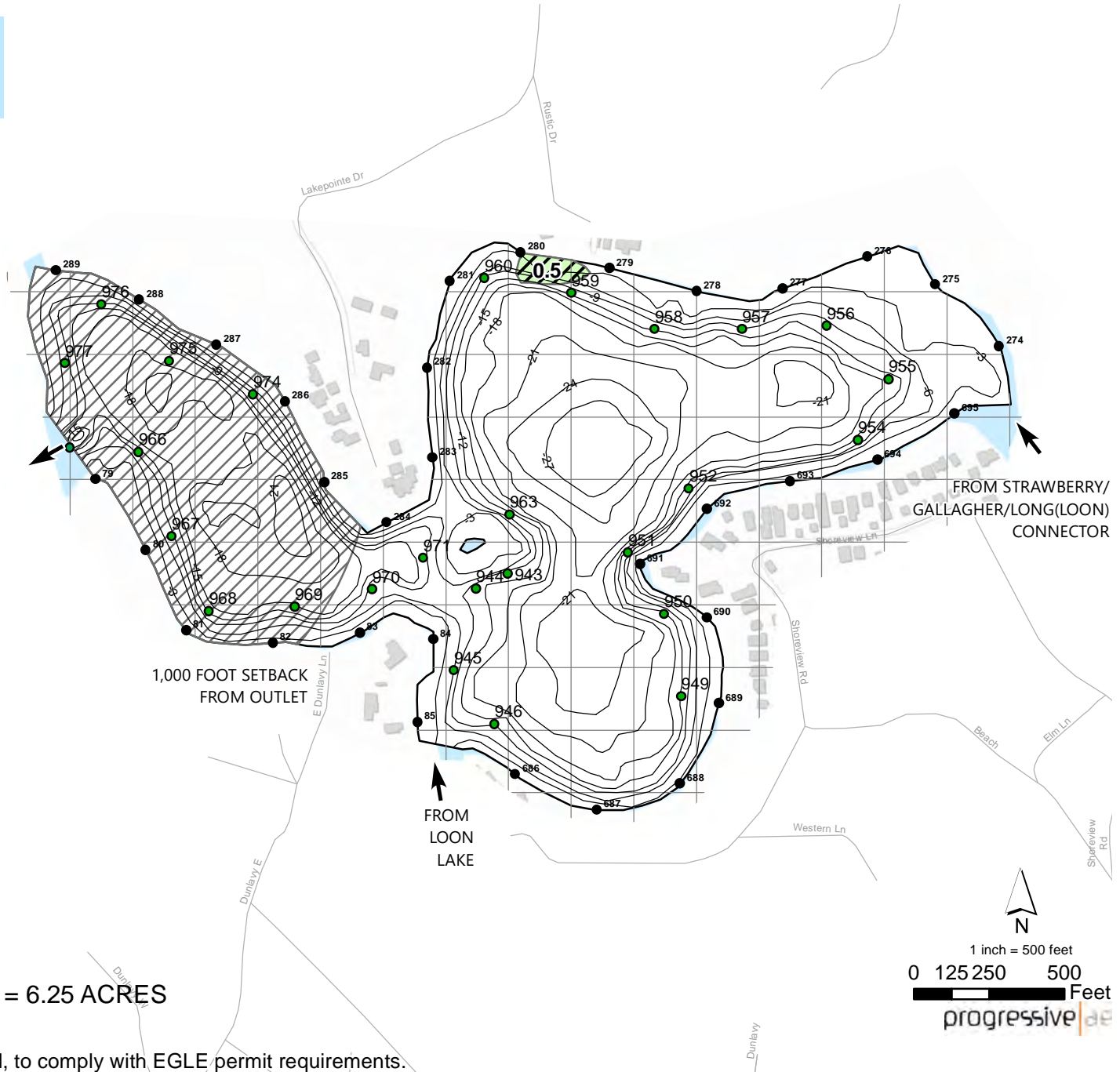

LAKE AREA = 69 ACRES
25% OF POTENTIAL SPAWNING AREA = 6.25 ACRES
REVISION DATE: JANUARY 2021

The applicator shall make adjustments, if needed, to comply with EGLE permit requirements.

