



BASELINE PORTAGE CONNECTOR LIVINGSTON COUNTY, MICHIGAN TREATMENT MAP SURVEY DATE: MAY 16TH, 2023

 = 1 ACRE

Treatment

 Flumioxazin @ 100 ppb + Diquat @ 1 gal/acre
for curly-leaf pondweed = 0.5 acres

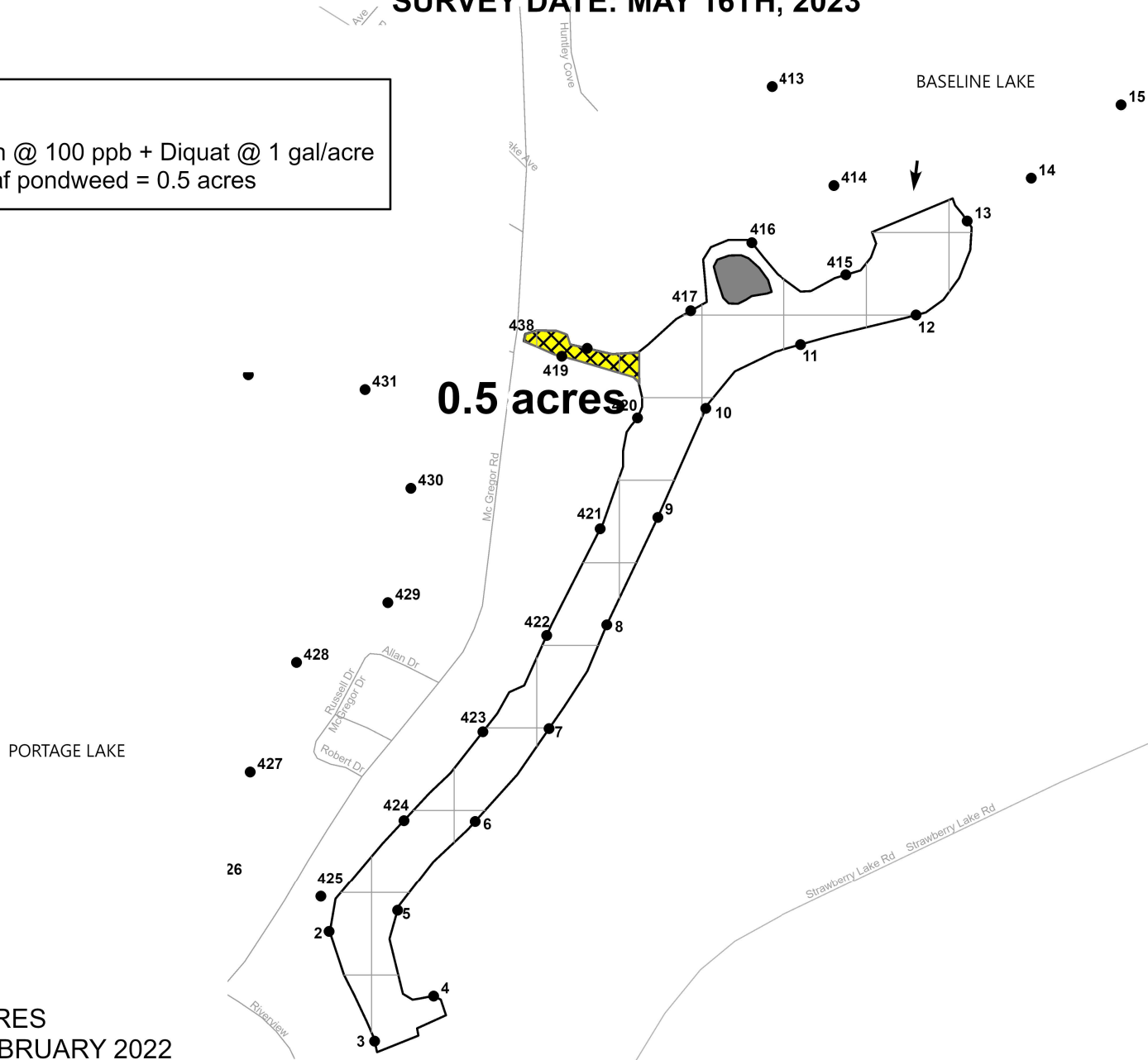

LAKE AREA = 10 ACRES
REVISION DATE: FEBRUARY 2022

The applicator shall make adjustments, if needed, to comply with EGLE permit requirements.

N

0 190 380
Feet

progressive|ae