

Treatment



Diquat dibromide @ 2 gal/acre for
flowering rush = 0.5 acres

**BASELINE PORTAGE CONNECTOR
LIVINGSTON COUNTY, MICHIGAN
TREATMENT MAP
SURVEY DATE: JUNE 12TH, 2023**

= 1 ACRE

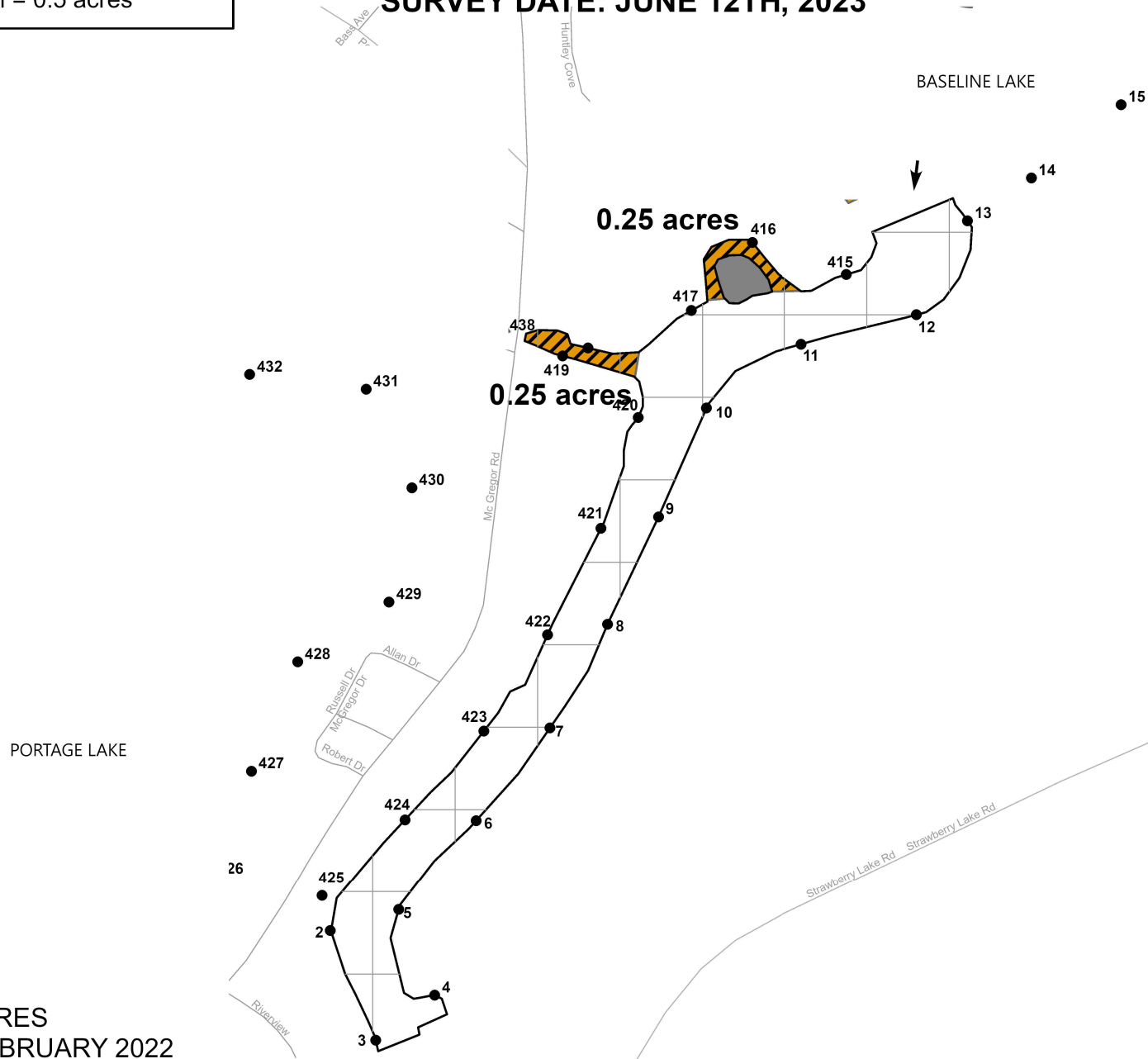

LAKE AREA = 10 ACRES
REVISION DATE: FEBRUARY 2022

The applicator shall make adjustments, if needed, to comply with EGLE permit requirements.

