

Treatment

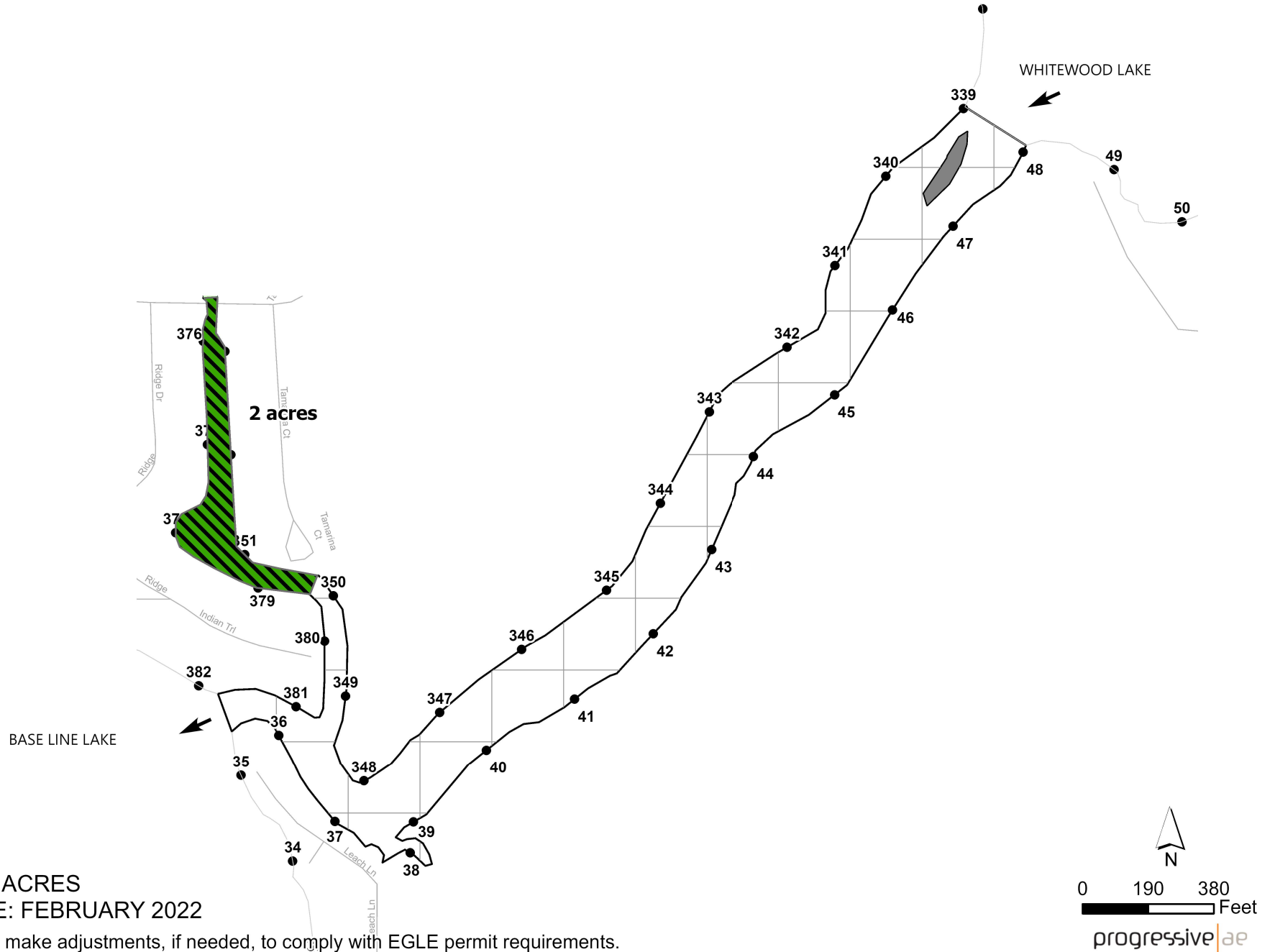

Chelated copper liquid @ EGLE max rate
for starry stonewort = 2 acres

**TAMARACK CONNECTOR
LIVINGSTON COUNTY, MICHIGAN
TREATMENT MAP
SURVEY DATE: JULY 11TH, 2023**

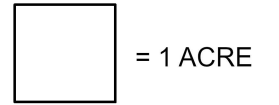

LAKE AREA: 16 ACRES
REVISION DATE: FEBRUARY 2022

The applicator shall make adjustments, if needed, to comply with EGLE permit requirements.

